



Sterling
HOMES

A QUALICO Company

HIGHLIGHTS

- Quartz Countertops throughout
- 30" Upper Cabinets
- Quartz Backsplash in Kitchen and Vanities
- Luxury Vinyl Plank Flooring Standard on Main Floor & Wet Areas
- Front Attached Garage
- Landscaping Included
- Closing Costs Included

WHY STERLING

- 10 YR Warranty Program with an incredible warranty team
- 70+ Years of Building Experience
- Homeowner Portal with 24 hour accessibility

Main Floor | 514 Sq. Ft.



Upper Floor | 518 Sq. Ft.

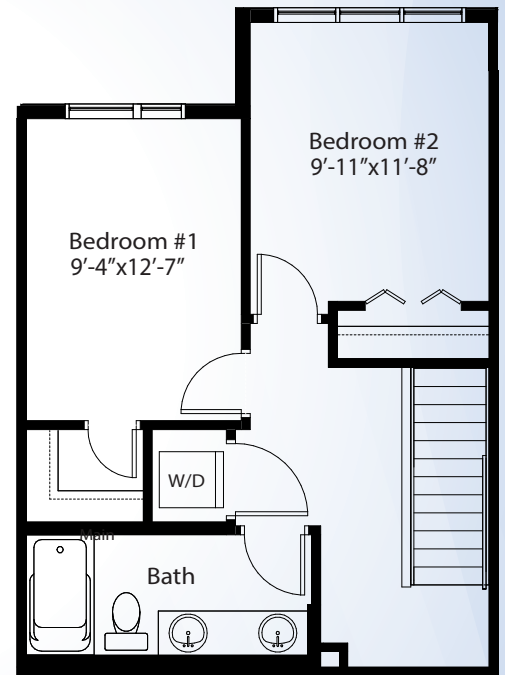

MAROON

Front Attached Townhome | 1,335 Sq. Ft.
2 Bed | 1.5 Bath

sterlingedmonton.com

Ground Floor

